

Report to:	Licensing and Regulatory Committee	Date of Meeting:	Monday 25 June 2018
Subject:	Gloucester Road, Bootle – Proposed Residents parking scheme		
Report of:	Head of Locality Services - Commissioned	Wards Affected:	Derby
Portfolio:			
Is this a Key Decision:	No	Included in Forward Plan:	No
Exempt / Confidential Report:	No		

Summary:

To report on the results of a consultation with residents and to recommend the progression of a residents parking scheme in Gloucester Road, Bootle between its junctions with Park Street and Oxford Road.

Recommendations:

It is recommended that subject to confirmation from Derby Ward Members regarding the funding for the scheme that Members:-

- (i) note the results of the consultation
- (ii) request Cabinet Member Locality Services to;
 - a) approve the introduction of the Residents Privileged Parking scheme in Gloucester Road between its junctions with Park Street and Oxford Road as shown in Annex A.
 - b) approve the revocation of the existing Traffic Regulation Orders, as described within the report;
- (iii) authorise the progression of the necessary Traffic Regulation Orders, including those of public consultation and advertising the Council's intention to implement the Order;
- (iv) in the event that no objections are received during the consultation process, referred to in (iii) above the Head of Regulation and Compliance be authorised to make the Order(s) and the Service Manager of Traffic and Transportation be authorised to implement the order and

- (vi) In the event that objections are received during the consultation process the matter be referred back to this Committee for consideration.

Reasons for the Recommendations:

The Council has the power to revoke a Traffic Regulation Order (Part IV of Schedule 9 to the Road Traffic Regulation Act 1984) as well as the power to make a new Traffic Regulation Order (Section 1 of that Act). Authorisation to advertise new Traffic Regulation Orders falls under the remit of Cabinet Member Locality Services.

Alternative Options Considered and Rejected: (including any Risk Implications)

None

What will it cost and how will it be financed?

(A) Revenue Costs

All costs associated with the introduction of the Traffic Regulation Orders, amounting to £1500 will be funded from the 2018/19 delegated budget for Derby Ward.

(B) Capital Costs

Nil

Implications of the Proposals:

Resource Implications (Financial, IT, Staffing and Assets): None
Legal Implications: None
Equality Implications: There are no equality implications

Contribution to the Council's Core Purpose:

Protect the most vulnerable: Will assist residents and other road users
Facilitate confident and resilient communities: Not applicable
Commission, broker and provide core services: Not applicable
Place – leadership and influencer: Not applicable
Drivers of change and reform: Not applicable
Facilitate sustainable economic prosperity: Not applicable
Greater income for social investment: Not applicable
Cleaner Greener: Not applicable

What consultations have taken place on the proposals and when?**(A) Internal Consultations**

The Head of Corporate Resources has been consulted and notes the report indicates all costs associated with the introduction of the Traffic Regulation Orders, amounting to £1500, will be funded from the 2018/19 delegated budget for Derby Ward. (FD 5137/18.)

Head of Regulation and Compliance has been consulted and has no comments on the report. (LD 4361/18)

(B) External Consultations

None

Implementation Date for the Decision

Immediately following the Committee / Council meeting.

Contact Officer:	Colin Taylor
Telephone Number:	Tel: 0151 934 4189
Email Address:	colin.taylor@sefton.gov.uk

Appendices:

There are no appendices to this report

Background Papers:

There are no background papers available for inspection.

1. Introduction/Background

- 1.1 Following continued complaints of obstructive parking by shoppers and workers from the Strand shopping centre and the office area, Derby Ward Members requested that a consultation exercise be carried out with residents in Gloucester Road, Bootle between its junctions with Park Street and Oxford Road.
 - 1.2 It was suggested that in order to prevent such parking, a residents parking scheme, in the form of a 'Permit Parking Area' (PPA) be introduced in the area, the cost of which would be funded from the Derby Ward delegated budget.
 - 1.3 The introduction of a PPA, similar to the one recently implemented as a Planning Condition linked to the Housing Market Renewal Initiative adjacent to Hugh Baird College, would simply require the provision of zone entry signs at both ends at the junctions with Park Street and Oxford Road. No further bay markings or signs would be required in the area, thus reducing initial costs and future maintenance costs. The only additional lines would be the introduction of double yellow line restrictions at the junction with Park Street.
- 1.4A plan showing the proposed PPA is attached as Annex A.

2.0 Consultation

- 2.1 A total of 25 consultation packs were hand delivered to all properties within the proposed PPA, as indicated in Annex B.
- 2.2 17 questionnaires were returned by the deadline, giving a response rate of 68%. This is considered normal for this type of consultation.
- 2.3 Out of the 17 returned questionnaires, 16 were in favour of the scheme, and 1 was against.

3.0 Proposal

- 3.1 Given the majority of 94% of respondents are in favour of the introduction of a Residents parking scheme, it is recommended that the PPA scheme be implemented.
- 3.2 A plan showing the proposed PPA scheme is attached as Annex A.
- 3.3 It is therefore recommended that Licensing and Regulatory Committee support the introduction of a Permit Parking scheme in Gloucester Road, and request Cabinet Member Transportation to authorise the advertising of the legal Traffic Regulation Order.

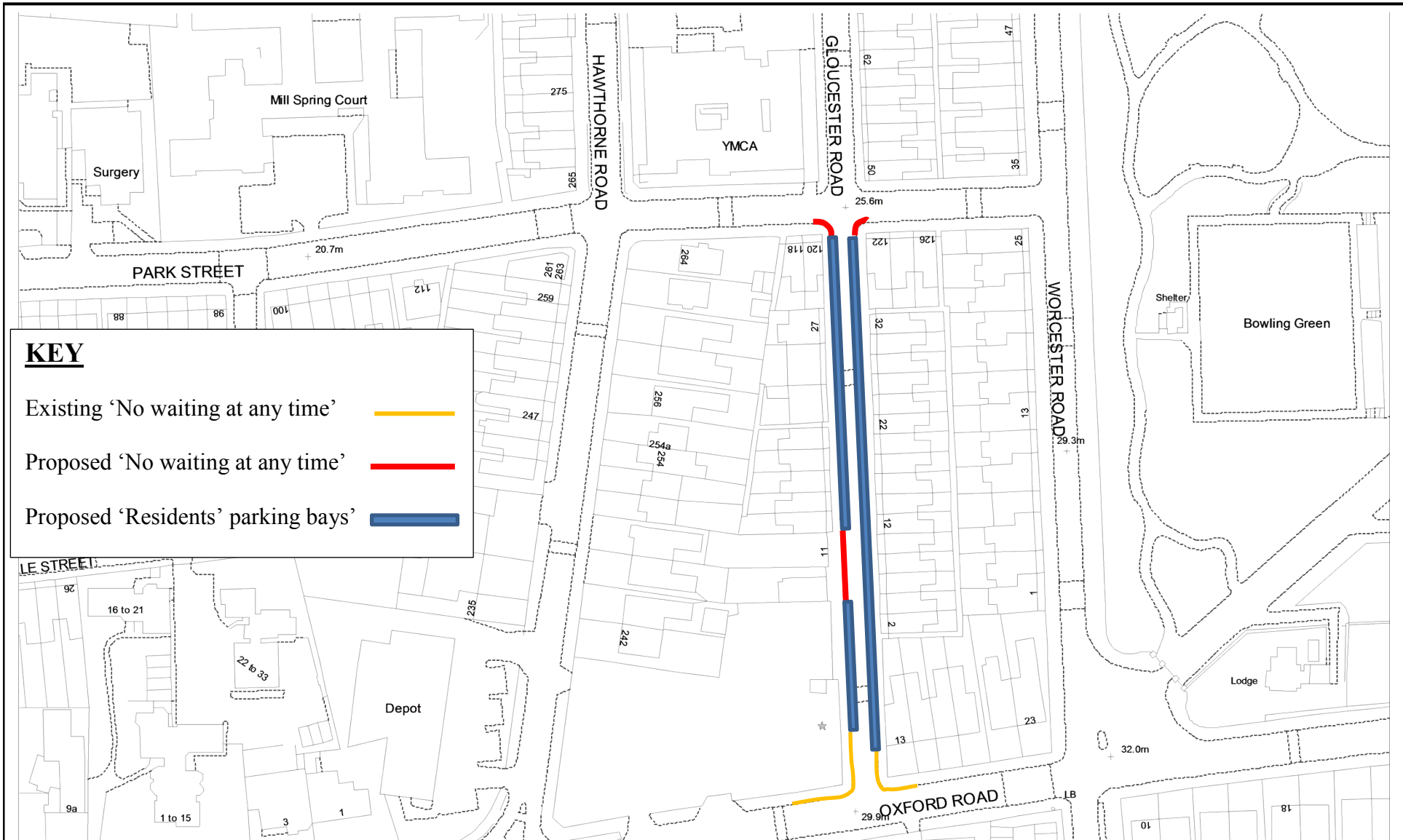

METROPOLITAN BOROUGH OF SEFTON

Jim Black
Head of Locality Services - Commissioned

Title
Gloucester Road, Bootle

Proposed residents' parking scheme

Drawn
SJ

Scale
NTS

Date
Nov 2017

SJ

NTS

Nov 2017

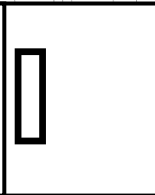

**PROPOSED RESIDENTS' PERMIT PARKING SCHEME
GLOUCESTER ROAD, BOOTLE
CONSULTATION**

Following complaints from residents regarding lack of on-street parking for residents on Gloucester Road, Bootle, Derby Ward Councillors have agreed to fund the introduction of a Residents' Parking scheme in this area.

A plan showing the proposed Residents' Parking Bays is enclosed with this letter. If the majority of residents agree with the proposals, and the scheme is approved by Cabinet Member – Locality Services, each of the residents living in Gloucester Road, between Oxford Road and Park Street will be eligible to apply for Residents' permits for each vehicle which is registered at their address. In addition, they may also apply for one Visitor's permit per property. Each permit (Resident's or Visitor's) will be subject to a one-off £30 registration fee, i.e. if you have two vehicles and also want the Visitor's permit, you will be charged a total of £90 for the three permits. If you change your vehicle in the future, you will be charged another £30 registration fee to change the Resident's permit.

If the scheme is progressed, only vehicles displaying a valid parking permit will be allowed to park in these bays, between 9.00 a.m. and 5.00 p.m. Mon - Fri. Outside of these hours, any vehicle is permitted to park.

The purpose of this consultation is to seek your views on the proposals. Included with this letter is a plan showing the proposals and a questionnaire. Please take the time to fill in the questionnaire and return it in the pre-paid envelope provided, to reach us **no later than Friday 16 February 2018**.

The results of the consultation will be taken to the Licensing and Regulatory Committee where Councillors will review all of your comments or objections and decide whether the scheme is taken forward. The next meeting of the committee will be on 19 March 2018 at 6.30 p.m. at the Town Hall, Southport. You are welcome to come along to that meeting.

If you require any further information before completing your questionnaire please read the attached 'Frequently Asked Questions' sheet, or phone our Contact Centre on 0845 140 0845 and leave a message for Colin Taylor. Colin will phone you back as soon as possible. Please let Colin know if you require this information in large print, or any other format.

**Many Thanks,
Jim Black
Head of Locality Services - Commissioned**



Please recycle - if you do not want to keep this leaflet, return it with your questionnaire and we will recycle it for you

Frequently Asked Questions

How much will the permits cost?

Each resident can apply for a Residents' permit for each vehicle which is registered at their address. In addition, they may also apply for one Visitor's permit per property. Each permit (Resident's or Visitor's) will be subject to a one-off £30 registration fee, i.e. if you have two vehicles and also want the Visitor's permit, you will be charged a total of £90 for the three permits. If you change your vehicle in the future, you will be charged another £30 registration fee to change the Resident's permit.

Do I have to pay for a new permit every year?

No – you will only have to pay once, when you initially apply for the permits. The only exception to this is if you change your vehicle and need a new permit with the new registration number on it.

Why should I pay to park in my own road?

Any vehicle can park on any public road provided it is legally taxed, tested and insured. What the residents' parking scheme does is prevent any vehicle from parking in your road unless it is displaying a permit. Effectively you are paying to prevent outsiders from taking up the parking spaces in your road.

Will the permit guarantee a parking space outside my own house?

No – all it will guarantee is to prevent outsiders taking up parking spaces in your road. You and your visitors will be able to park anywhere in the road, but generally most residents will tend to park outside their own houses.

Who will enforce the scheme?

Sefton's own parking attendants will regularly patrol each of the roads throughout the day, and issue tickets on any vehicle which does not display a valid permit.

What will be the hours of operation?

The scheme is aimed at preventing office workers from parking in your road during weekdays, so the scheme will operate Monday to Friday, 9:00 a.m. to 5:00 p.m. In the evenings and at weekends, vehicles may park without having to display a permit.

Will I be able to receive deliveries?

Yes – Any vehicle will be able to park and unload goods without having to display a permit.

This is just a way of the Council making money!

The £30 registration fee for each permit simply covers staff time in receiving applications, inputting your details onto our records, printing off the permit and posting the permit out to you. All other costs, such as this consultation, production of Committee reports, advertising the legal Order in the local Papers and provision of signs and carriageway markings are being funded by the Council in order to provide a service to residents. Sefton Council will make no money from this scheme.



Please recycle - if you do not want to keep this leaflet, return it with your questionnaire and we will recycle it for you